

0.35mm pitch Board to FPC Connector

FB35S Series



OUTLINE

FD35S series is a 0.35mm pitch board to FPC connector with a stacking height of 0.7mm.

The FB35S is a shorter version of our FB35 series connectors with the width reduced from 2.3mm to 2.1mm.

Each connector has two locking tabs that also serve as power contacts with each having the capability of supporting 4A of current, which can reduce the number of overall connections, the size of your device and the cost associated with reduced board space.

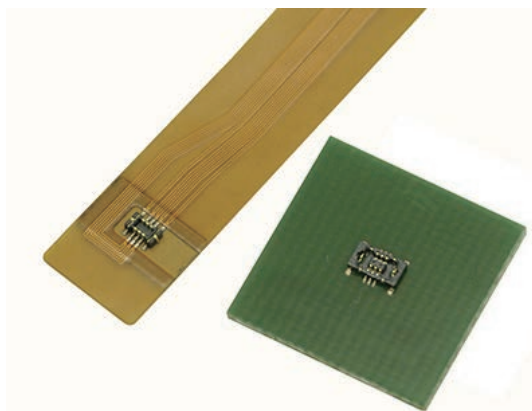

FEATURE

- Stacking height is 0.7mm.
- Pitch 0.35mm
- Available pin counts: 6,12,16
- Reduced board space due to ultra short width of 2.1mm.
- The retention tabs serve as power contacts with up to 4A current available in each of two pins, which allows for more efficient use of the available connection pins.
- The retention tabs of the receptacle connector are assembled by insert molding making a more robust structure to withstand manual assembly.
- Manual assembly improved due to click feel when engaged.

APPLICATIONS

Mobile phone, Wearable devices, PDA, Compact portable devices

SPECIFICATIONS

Rated Voltage	30VAC (r.m.s.) / 30VDC
Rated Current	0.3A Signal Contact(Total 12A max.) 4.0A Power Contact
Insulation Resistance	1,000 MΩ min. / 250VDC
Dielectric Withstand Voltage	AC 200V (r.m.s.) / 1 minute
Contact Resistance	50 mΩ max. Signal Contact 20 mΩ max. Power Contact
Operating Temperature	-40°C ~ +85°C

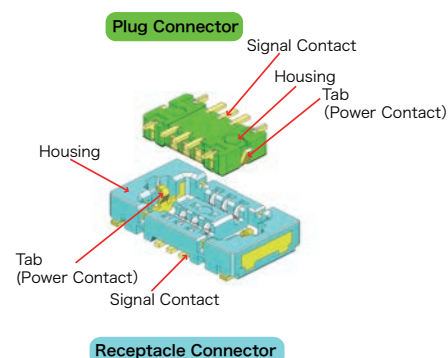

MATERIAL /FINISH



Item	Material / Finish
Signal Contact	Copper Alloy/Au over Ni Plating
Housing	LCP Resin (UL94V-0) / Black
Power Contact	Copper Alloy / Au over Ni Plating

© Specifications and/or dimensions in this catalogue are subject to change without notice.
Your catalogue checking the latest specifications with our drawings would be highly appreciated.

0.35mm pitch Board to FPC Connector

Plug Connector

FB35S - PA12-3A

Series Name
FB35S : 0.35mm pitch Board to board
connector, stacking height 0.7mm
Receptacle connector width 2.1mm

Contact Plating
3 : Au(Flash) over Ni Plating

Number of Contact
See Table-1

Mating Style
P : Plug

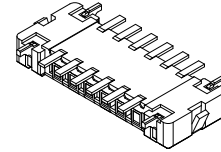
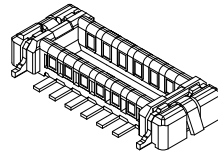
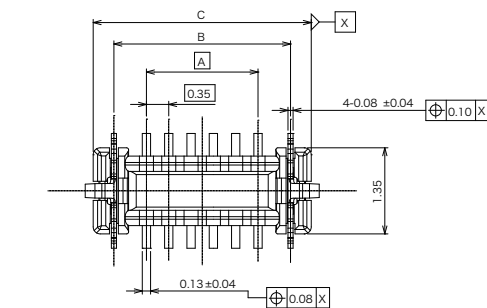

Solid View

(Number of contact is 12 + 2)

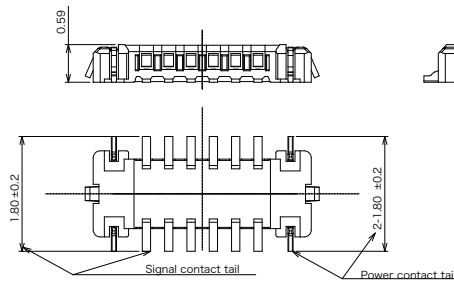

GENERAL TOLERANCE	
X<5	±0.15
5≤X<15	±0.25
15≤X	±0.40
ANGLE	±3°

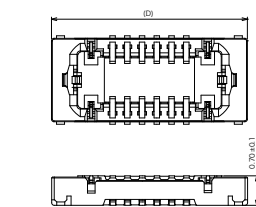

Connector mating condition

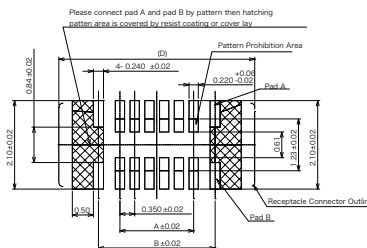

Recommended PCB Layout type 1
(Connector Mounting Side View)
Type 1 case is normal layout

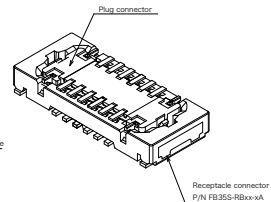

Table-1 ※ Regarding the number of contact, please contact our sales.

Part Number	Number of Contact	A	B	C	D	E
FB35S-PA6-3A	6	0.70	1.72	2.36	3.60	0.88
FB35S-PA12-3A	12	1.75	2.77	3.41	4.65	1.93
FB35S-PA16-3A	16	2.45	3.47	4.11	5.35	2.63

▶ 0.35mm pitch Board to FPC Connector

Receptacle Connector

FB35S - RA12-3A

Series Name

FB35S : 0.35mm pitch Board to board connector, stacking height 0.7mm
Receptacle connector width 2.1mm

Contact Plating
3 : Au(Flash) over Ni Plating

Number of Contact
See Table-1

Mating Style
R : Receptacle

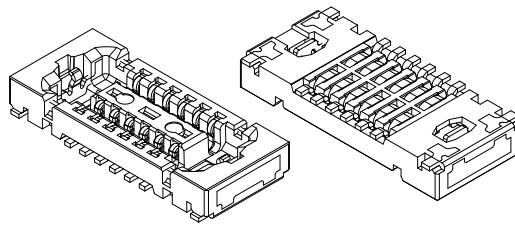
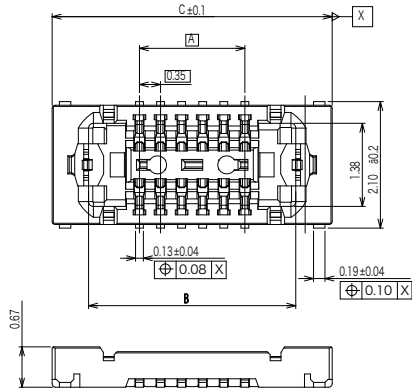

Solid View
(Number of contact is 12 + 2)

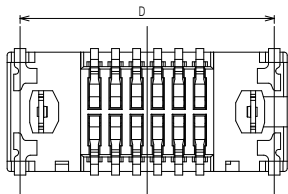

GENERAL TOLERANCE	
X<5	±0.15
5≤X<15	±0.25
15≤X	±0.40
ANGLE	±3°

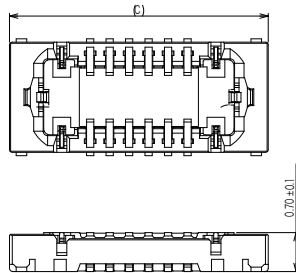

Mating condition

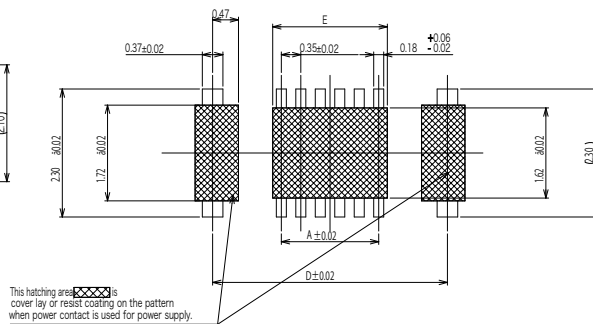
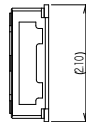

This hatching area is cover lay or resist coating on the pattern when power contact is used for power supply.

Reference PCB Layout
(Connector Mounting Side View)

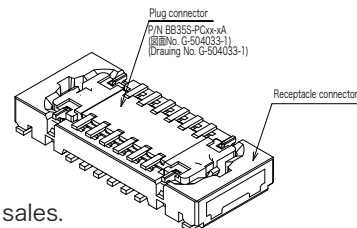

Table-2 ※ Regarding the number of contact, please contact our sales.

Part Number	Number of Contact	A	B	C	D	E
FB35S-RA6-3A	6	0.70	2.39	3.60	3.17	1.05
FB35S-RA12-3A	12	1.75	3.44	4.65	4.22	2.10
FB35S-RA16-3A	16	2.45	4.14	5.35	4.92	2.80

© Specifications and/or dimensions in this catalogue are subject to change without notice.
Your catalogue checking the latest specifications with our drawings would be highly appreciated.

<https://www.connector.fujikura.com>