

# M12 Sized & Sealed Circular Connector

## CM02B Series

Conforming  
Standard

NECA 4202

Waterproof

IP 67

Size

M12

Lock Type

Threaded  
Coupling

### ◆ OUTLINE

The CM02B series is a M12 sized and sealed circular connector developed for the connection of various sensors equipment.

This series conforms to NECA 4202, official standard of the Japan Electric Control Equipment Industry Association.

The use of the CM02B series will drastically decrease wiring work man-hours needed to connect sensors.

The CM02B series can be used in harsh environmental condition, having IP67 rated for protection against moisture and dust.

This series is also intemateable with our CM01 series.



### ◆ APPLICATIONS

1. Various sensors
2. Measurement equipment, medical equipment, telecommunications equipment, and various other electronic and electric equipment

### ◆ FEATURES

- UL94V-0 insulator flammability rating
- Over molding style cable assembly
- Number of Contacts : 4

### ◆ SPECIFICATIONS

|                                 |  |                              |
|---------------------------------|--|------------------------------|
| Rated Current                   | 3A/Contact   |                              |
| Rated Voltage                   | 125V DC  |                              |
| Dielectric Withstanding Voltage | 1,500V AC for 1 minute   |                              |
| Insulation Resistance           | 1,000 MΩ Min. / Connector  | 100 MΩ Min. / Cable assembly |
| Operating Temperature Range     | -25°C to +70°C   |                              |
| Waterproof                      | IP67 when mated  |                              |
| Cable                           | Conductor Size : 20AWG / Colored, 1-Brown 2-White 3-Blue 4-Black |                              |

### ◆ MATERIALS/FINISH



|                    |   |
|--------------------|---|
| Insulator          | Plastic(UL94V-0)                            |
| Contact            | Copper Alloy / Gold Plating                 |
| Coupling Ring      | Zinc Alloy / Nickel Plating                 |
| Shell              | Zinc Alloy or Copper Alloy / Nickel Plating |
| Nut & Washer       | Zinc Alloy or Copper Alloy / Nickel Plating |
| Gasket             | Synthetic Rubber / Black                    |
| Over Molding Resin | Plastic(UL94V-0)/Gray                       |

© Specifications and/or dimensions in this catalog are subject to change without notice. © Your checking the latest specifications with our drawings would be highly appreciated.

<https://www.connector.fujikura.com>  
250401

## ▶ Double-Ended Cable Assemblies

- A plug connector with socket contacts and a jack connector with pin contacts

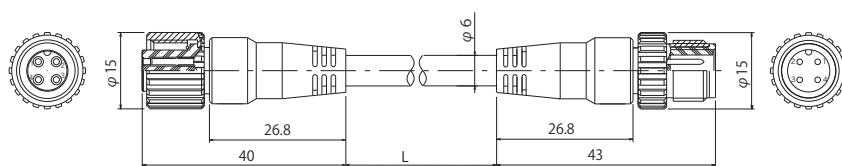

| L      | P/N                  |
|--------|----------------------|
| 1,000  | CM02BA-8DP4S-010(R1) |
| 2,000  | CM02BA-8DP4S-020(R1) |
| 3,000  | CM02BA-8DP4S-030(R1) |
| 5,000  | CM02BA-8DP4S-050(R1) |
| 10,000 | CM02BA-8DP4S-100(R1) |

## ▶ Single-Ended Cable Assemblies

- Jack connector with pin contacts

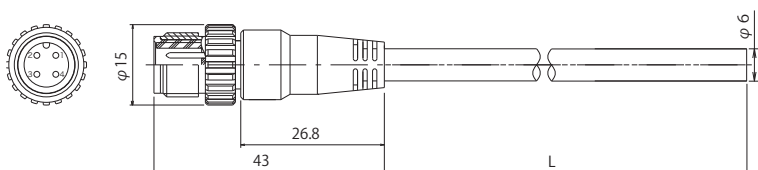

| L      | P/N             |
|--------|-----------------|
| 1,000  | CM02B-8DJ4P-010 |
| 2,000  | CM02B-8DJ4P-020 |
| 3,000  | CM02B-8DJ4P-030 |
| 5,000  | CM02B-8DJ4P-050 |
| 10,000 | CM02B-8DJ4P-100 |

- Plug connector with socket contacts

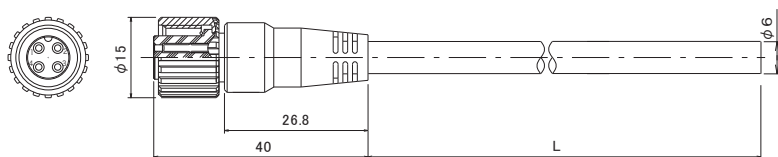

| L      | P/N                 |
|--------|---------------------|
| 1,000  | CM02B-8DP4S-010(R1) |
| 2,000  | CM02B-8DP4S-020(R1) |
| 3,000  | CM02B-8DP4S-030(R1) |
| 5,000  | CM02B-8DP4S-050(R1) |
| 10,000 | CM02B-8DP4S-100(R1) |

## ▶ Double-Ended Cable Assemblies

- Jack connectors with pin contacts on both ends

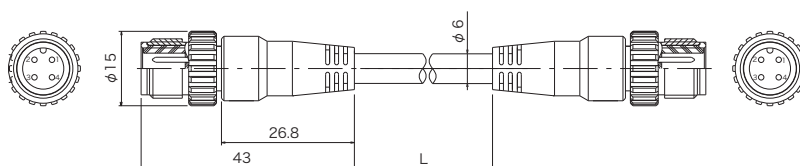

| L      | P/N                  |
|--------|----------------------|
| 1,000  | CM02BC-8DJ4P-010(R1) |
| 2,000  | CM02BC-8DJ4P-020(R1) |
| 3,000  | CM02BC-8DJ4P-030(R1) |
| 5,000  | CM02BC-8DJ4P-050(R1) |
| 10,000 | CM02BC-8DJ4P-100(R1) |

- Plug connectors with socket contacts on both ends

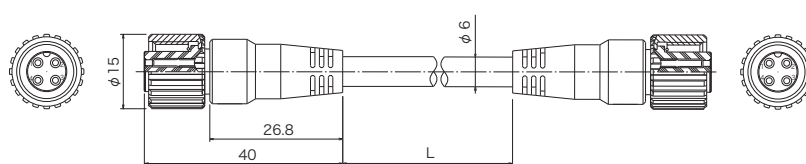

| L      | P/N                  |
|--------|----------------------|
| 1,000  | CM02BB-8DP4S-010(R1) |
| 2,000  | CM02BB-8DP4S-020(R1) |
| 3,000  | CM02BB-8DP4S-030(R1) |
| 5,000  | CM02BB-8DP4S-050(R1) |
| 10,000 | CM02BB-8DP4S-100(R1) |

## ► Y-Joint Adapter

- Double-ended cable assemblies

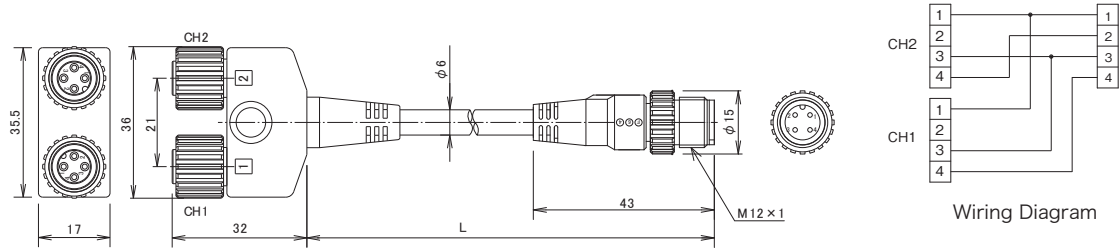

| L     | P/N                 |
|-------|---------------------|
| 500   | CM02B-8DYC4-005(R1) |
| 1,000 | CM02B-8DYC4-010(R1) |
| 2,000 | CM02B-8DYC4-020(R1) |
| 3,000 | CM02B-8DYC4-030(R1) |
| 5,000 | CM02B-8DYC4-050(R1) |

- Connectors on both ends without cable

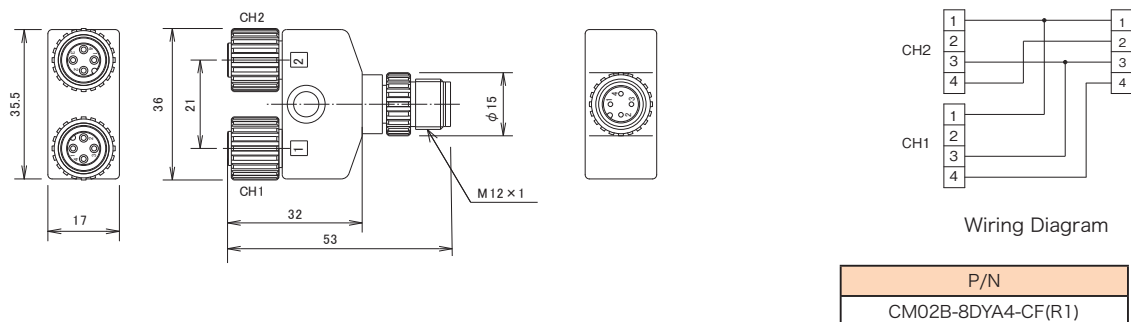

| P/N                |
|--------------------|
| CM02B-8DYA4-CF(R1) |

## ► Receptacle with Plastic Shell and Pin Contacts

### Solder Dip

- Rear-mount configuration

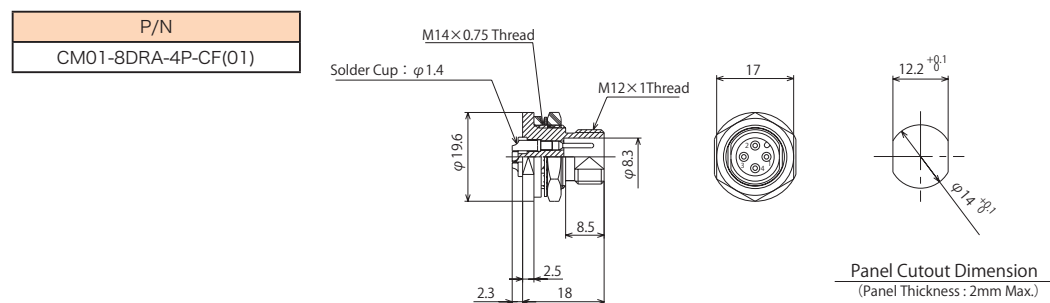

### Soldering

- P C B Contacts
- Rear-mount configuration

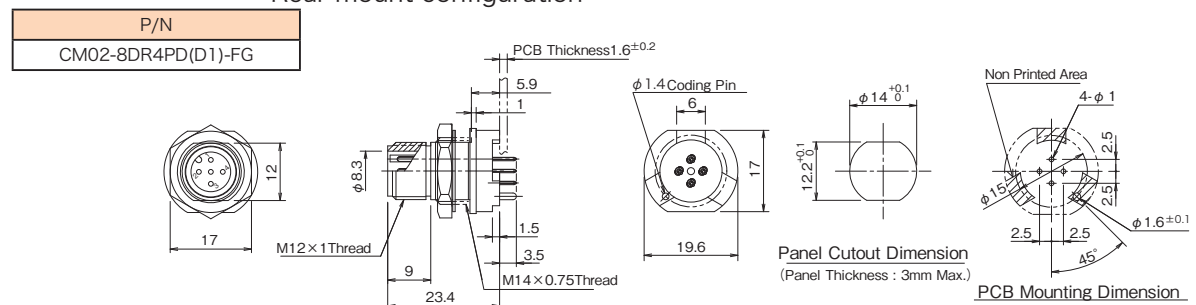

## ▶ Plug Receptacle with Metal Shell and Socket Contacts

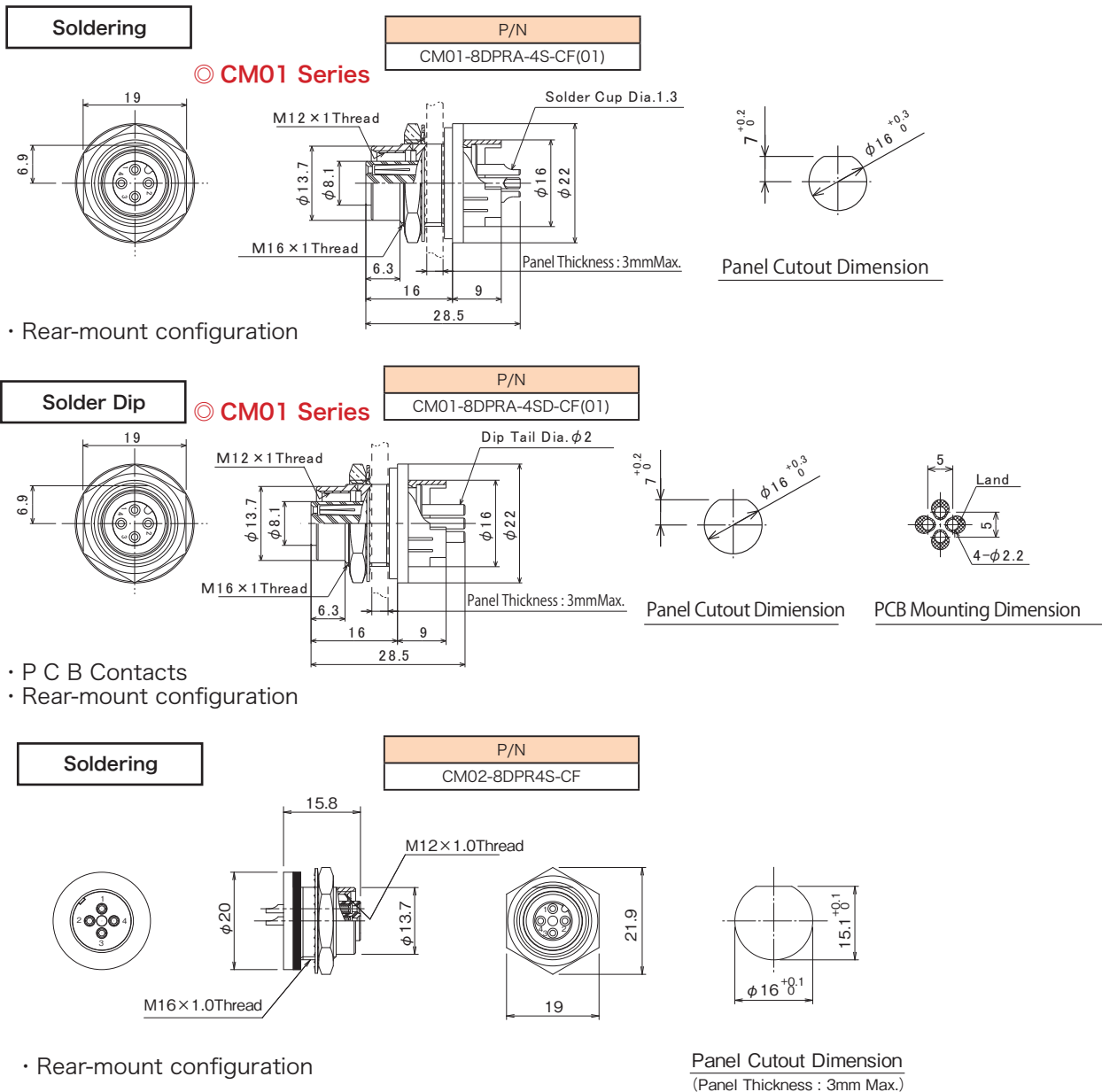

## ▶ Plug Insert Assembly with Socket Contacts for PCB Mount

- P C B Contacts
- No shell

| P/N                |
|--------------------|
| CM02-8DP4SD(D1)-FG |

Please verify that above P/N is NOT waterproof type.

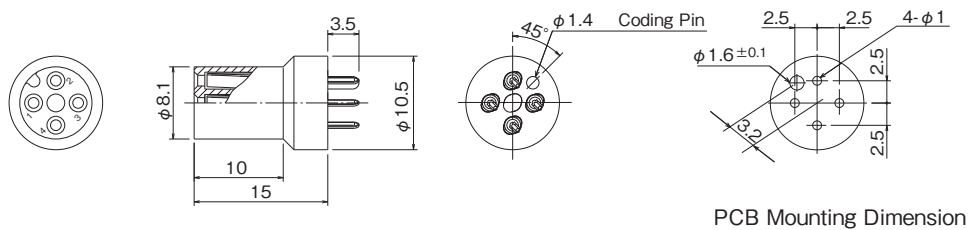

## ▶ Dust Cap for Plug & Plug Receptacle

| P/N           |
|---------------|
| CM01-P-CAP-CF |

Metal Cap

Copper Alloy/Nickel Plating

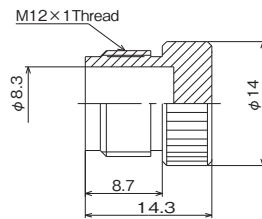

| P/N            |
|----------------|
| CM04-PR-DC(R1) |

Plastic Cap

Plastic/Clear

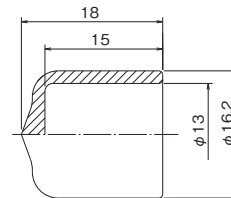

## ▶ Dust Cap for Jack & Receptacle

| P/N           |
|---------------|
| CM01-R-CAP-CF |

Metal Cap

Copper Alloy/Nickel Plating

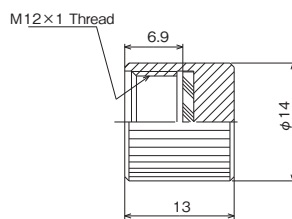

| P/N            |
|----------------|
| CM01-R-CAP(D1) |

Metal Cap

Aluminum Alloy

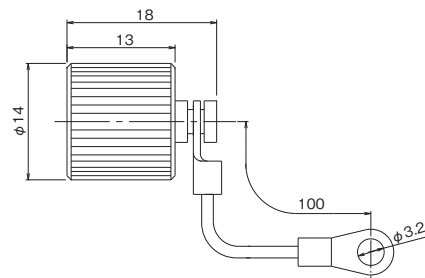

| P/N          |
|--------------|
| CM01-CAP(R1) |

Plastic Cap

Plastic/Black

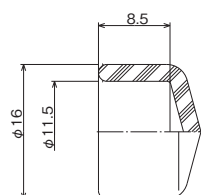

| P/N            |
|----------------|
| CM02B-J-DC(R1) |

Plastic Cap

Plastic/Clear

